

EXPERT SRF – Standard Rotary Filler



ICE GROUP

For family tubs
and impulse products!

EXPERT SRF AT A GLANCE:

- ⇒ **Automatic, rotary, filler:**
 - **1-wide** for family packs
 - **2- or 3-wide** for cups and cones
- ⇒ **Modern, compact construction; big capacity and completely automatic work, even with complicated products (from 10 to 25 cycles per minute)**
- ⇒ **Simple operation, quick and easy change-over (few machine operators required)**
- ⇒ **CIP cleaning**
- ⇒ **Only the best components recognized worldwide**
- ⇒ **Individually designed according to Customer's request.**



REAL ALTERNATIVE TO EQUIPMENT OF TRADITIONAL MARKET LEADERS

EXPERT SRF – Standard Rotary Filler

electric box IP 65
with touch screen panel

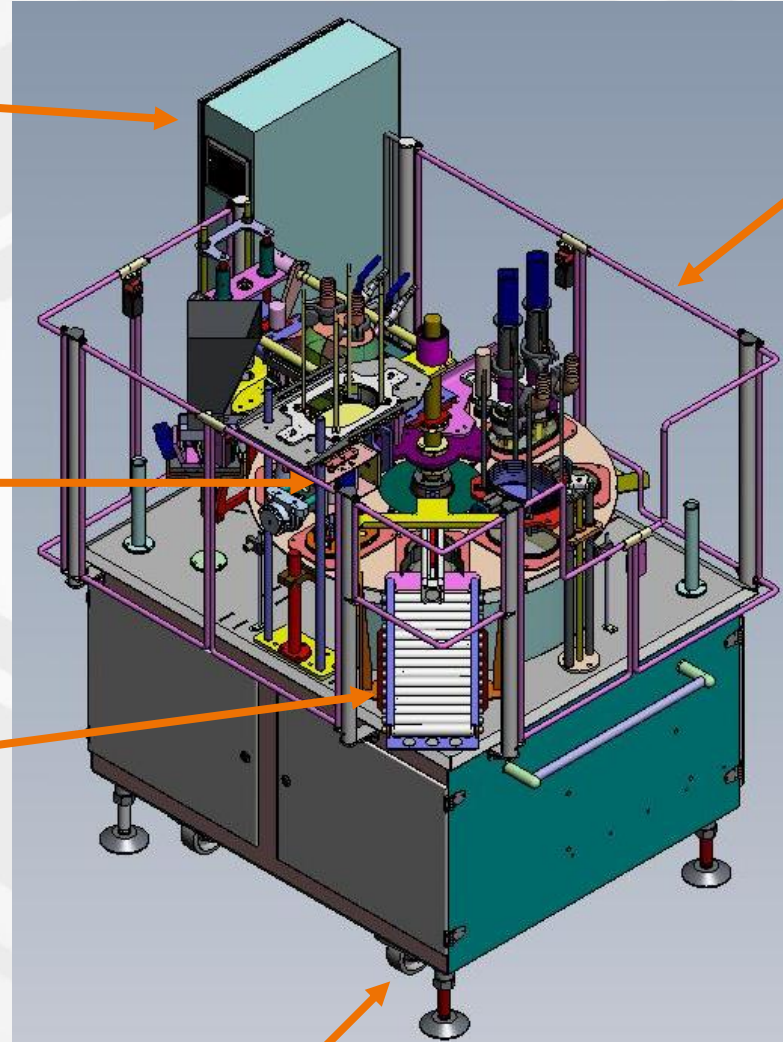
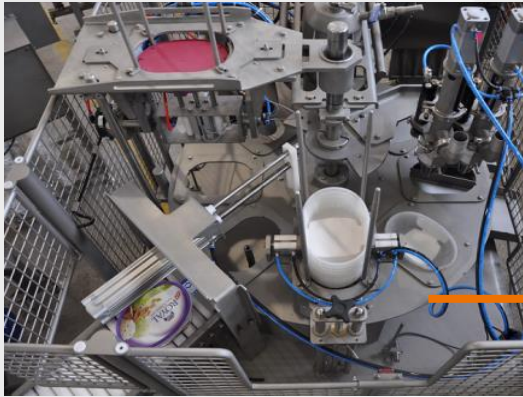

CE standard safety shields

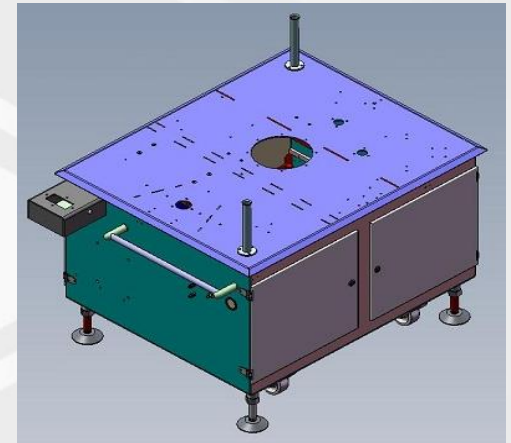

Highest hygiene standards!
Construction from bent
stainless steel sheets for
higher work hygiene (no
frames, made of painted,
galvanized or aluminum
elements, no dead corners
or hidden gaps)

main frame on lockable wheels, easy to move

EXPERT SRF – Standard Rotary Filler

EXPERT SRF CONTROL PANEL:

- ⇒ SIEMENS or ALLEN BRADLEY control panel with full colour touch screen display
- ⇒ Touch screen panel easy to operate and translated to local language
- ⇒ quick and easy change-over to another product
- ⇒ possibility of regulating, and adjusting all pneumatical functions without stopping the machine

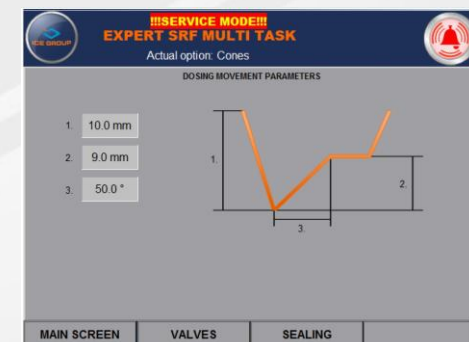
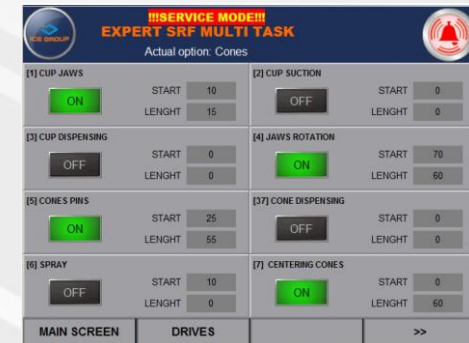

EXPERT SRF – Standard Rotary Filler

Expert SRF 1 – for take-home tubs:

CONTAINERS NOT REQUIRING SEATS (EXAMPLE):

Tubs' maximum diameters:

⇒ rectangular : L235/W155/H140 mm

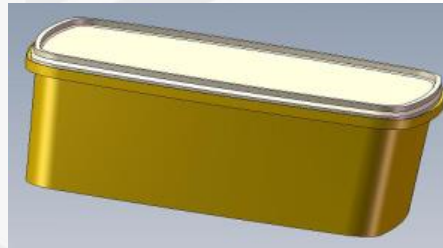

CONTAINERS REQUIRING SEATS (EXAMPLE):

Tubs' maximum diameters:

⇒ round : Ø140/H140

⇒ rectangular : L215(220)/W135(140)/H140 mm

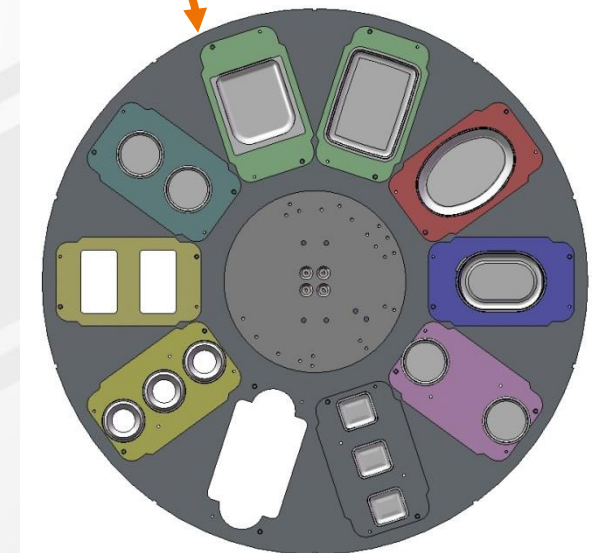
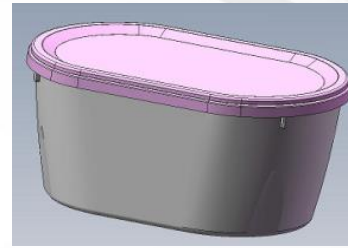

EXPERT SRF – Standard Rotary Filler

GALLERY

Expert SRF 1



EXPERT SRF – Standard Rotary Filler

GALLERY

Expert SRF 2



EXPERT SRF – Standard Rotary Filler

GALLERY

Expert SRF 3

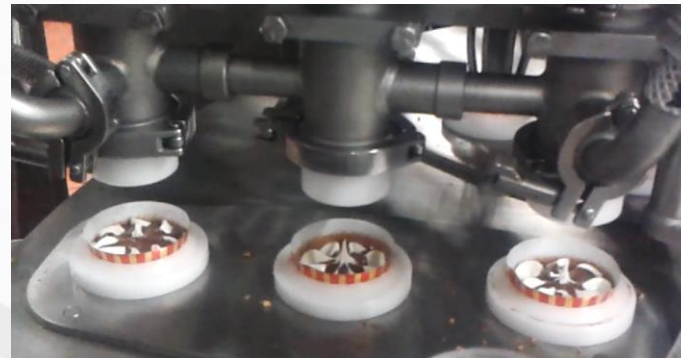
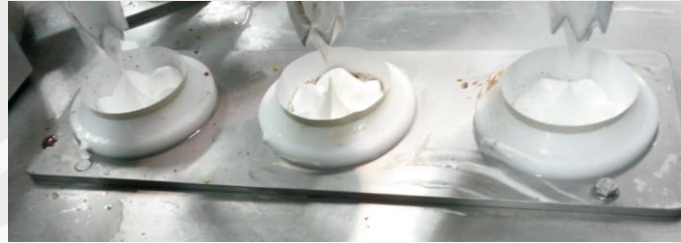

EXPERT SRF – Standard Rotary Filler

ALL ICE GROUP DOSERS CAN BE APPLIED:

⇒ NON-SWIRL DOSERS 1, 2, 3-colour also with sauce stripes and pencils

Time-lap



Star 1000



„Tartuffo“

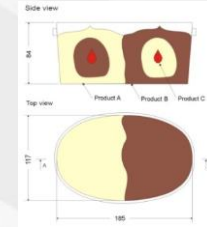

Zebra dozer

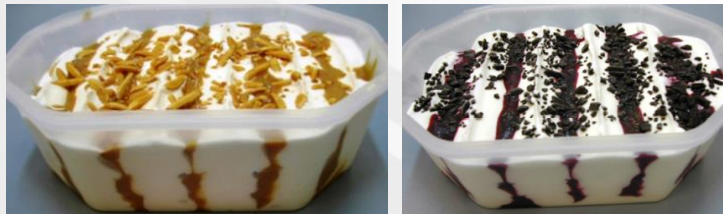

Radial partitioning



⇒ SWIRLING DOSERS

Star 3000



Cobra



SPECIAL DOSING & DECORATING POSSIBILITIES

⇒ Multi rosettes filling head



⇒ Dry topping (crumbles)



⇒ Decoration with rosettes/bulbs



⇒ American Ice Cream dosing



⇒ EXTRUDED PRODUCTS

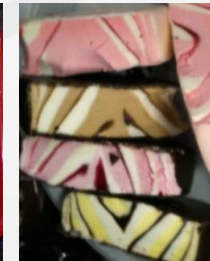

EXPERT SRF – Standard Rotary Filler

EXPERT SRF 1

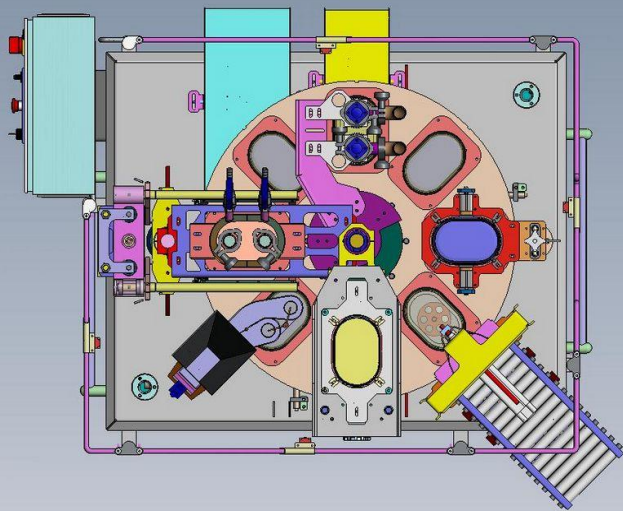
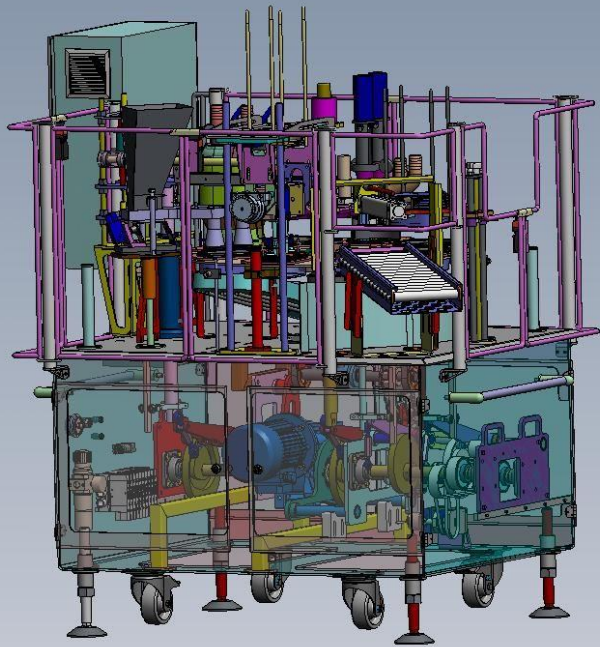

TECHNICAL DATA:

Capacity (max) – up to 1500 psc/h

Power installed – 2.8 kW

Frequency – 50 Hz

Voltage – 3x400 V

Air pressure – 6 bar

Air consumption – 2500 l/min

Width – ~1410 mm

Length – 1790 mm

Height – 1887 mm

Net weight – ~490 kg

EXPERT SRF – Standard Rotary Filler



TECHNICAL DATA:

Capacity (max) – up to 3800 psc/h

Power installed – 7 kW

Frequency – 50 Hz

Voltage – 3x400 V

Air pressure – 6 bar

Air consumption – 2000l/min

Width – ~1555 mm

Length – ~2000 mm

Height – ~2180 mm

Net weight – ~1102 kg

EXPERT SRF 2

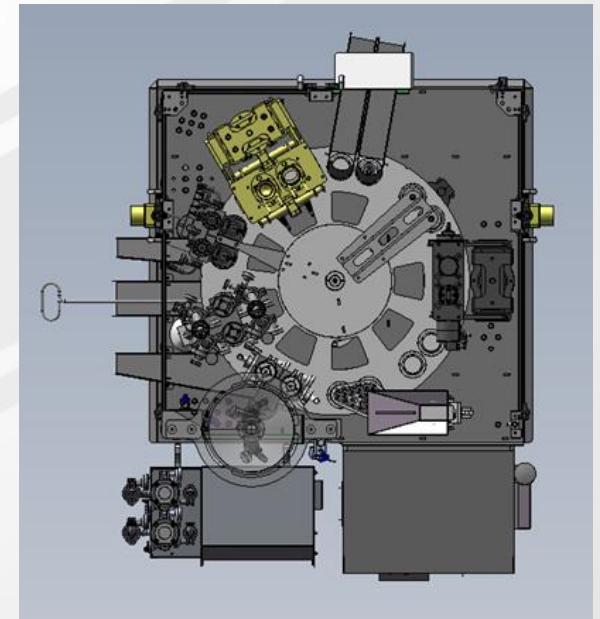

EXPERT SRF – Standard Rotary Filler



ICE GROUP

EXPERT SRF 3

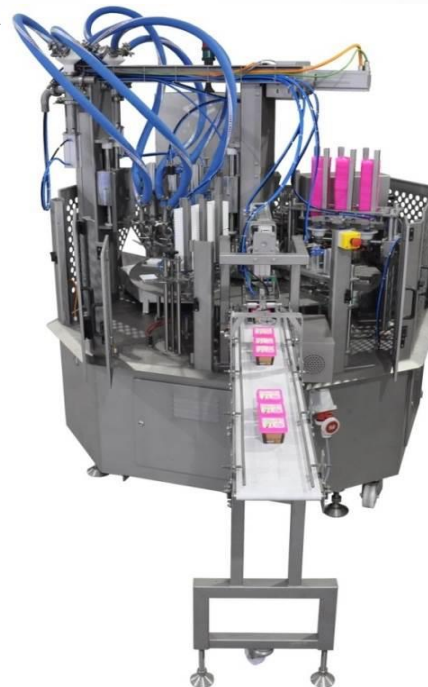
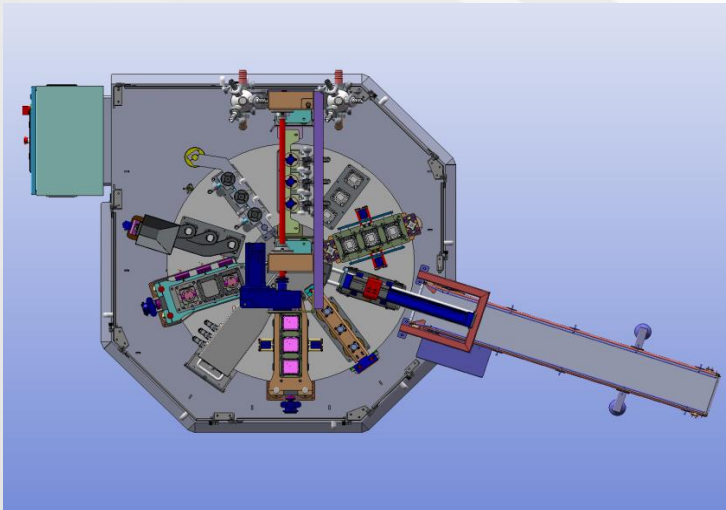
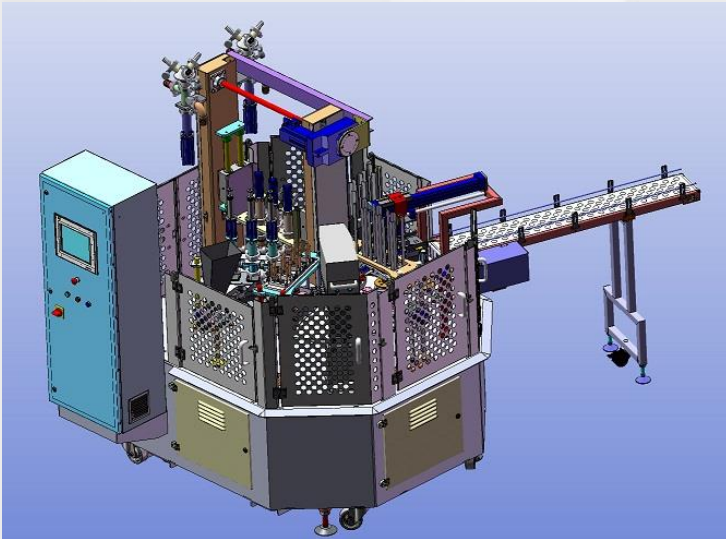

TECHNICAL DATA:

Capacity (max) – up to 5600 psc/h

Power installed – 3.8 kW

Frequency – 50 Hz

Voltage – 3x400 V

Air pressure – 6 bar

Air consumption – 1500l/min

Width – ~1920 mm

Length – ~2250 mm

Height – ~2270 mm

Net weight – ~1140 kg

Auxiliary Accessories – Master FF fruit feeders and pumps:



**Master FF 2000
fruit feeder with
CCF (Constant
Crispies Feeder)**



**Master FF 3000 Dual
fruit feeder with
divided tank**



**Three piston pumps for
syrup with divided hopper**



**One piston pump for syrup or
chocolate with heated hopper**



Worm syrup pump



**Two piston pumps for syrup
with divided hopper**



Cam pump for syrup

EXPERT SRF – Standard Rotary Filler

Different Ice Group's dozers possible to be applied on Expert SRF: for one ice cream colour, two ice cream colours, with pencil filler, with external sauce streaks - regular and irregular, big and extra large inclusions inside, rosette, multi-rosette...



COMMERCIAL DIVISION



Reema Handall

Commercial Division Coordinator



English- Arabic- and French-speaking markets
Middle East, North Africa



Ewa Bernacka

Commercial Division Administrator



English- and German-speaking markets
Europe, Asia, Africa



Agnieszka Gańczorz

Export specialist



English- and Spanish-speaking markets,
Middle, South & North America, Europe, India



Aleksander Zinkowski

Export specialist



Russian-speaking markets
Russia, Ukraine, Belarus, Kazakhstan

BOARD OF DIRECTORS

L. Arkadiusz Geratowski



President and Commercial Director



Mariusz Goik

General Manager and Vice President



Leszek Korzeń

Financial Manager and Vice President



Ice Group Sp. z o.o.

ul. Kadłubka 43

44-270 Rybnik, POLAND

Tel. +48 -32-42-29-835 ~6

Tel. +48 -32-71-08-520 ~3

e-mail: icegroup@icegroup.pl

www.icegroup.pl

